

High-end projector

PJ KU12000

RICOH
imagine. change.

☑ Projector

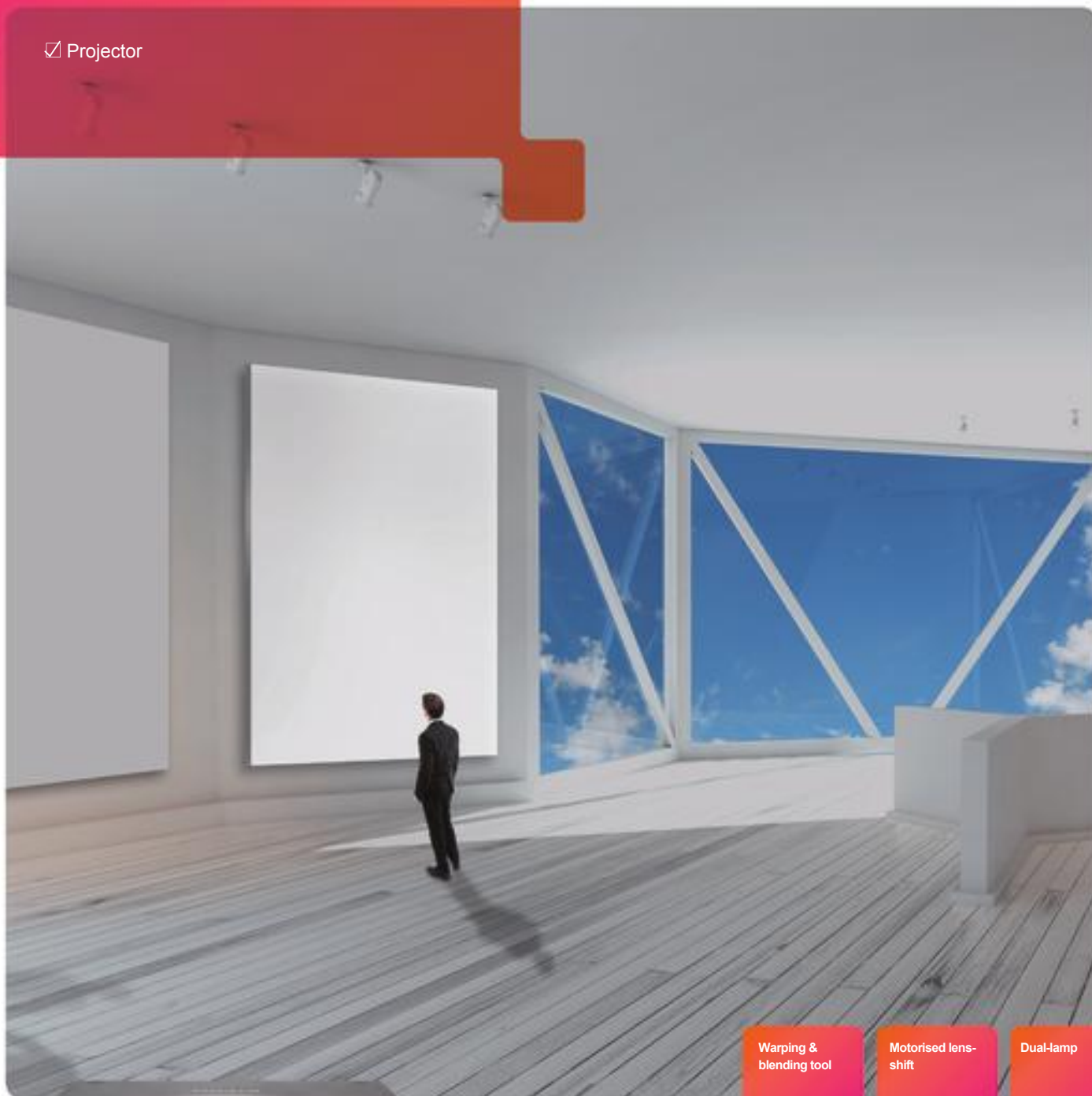

Warping &
blending tool

Motorised lens-
shift

Dual-Hamp

12,000 lm

Picture In
Picture

77.6m
projection
distance

The perfect image. Every time.

A high-end projector that can offer you only the highest image quality – this advanced device is perfect for museums, art galleries and hotels – or for signage use or wall-based presentations. Thanks to its V/H Keystone, 4-point and V/H Pincushion correction, you can maintain wider and crisper images on a larger scale, so whatever you're projecting, the images look as good as they can possibly look. And thanks to its motorised lens-shift, you can change projection vertically and horizontally without moving the projector.

- High brightness (12k lm) with DLP (1-chip) and dual lamp
- High-quality wide-screen images - WUXGA
- Project from any distance
- 360-degree projection
- Align your image in the screen



Project clearly. Project widely. Project accurately.

Let your projections shine.

You can showcase brighter images at up to 12,000 lm and really let your installations or videos get their messages across thanks to wider and crisper image sharing. The PJ KU12000 can easily project images which look square on cylindrical, spherical or differently shaped screens without distortion and the dual lamp feature also enables you to avoid interruptions during your event.



The best view. From wherever you choose.

With motorized lens shift, you can change projection vertically and horizontally without moving the projector and it's so flexible it can be installed at any angle. So it's perfect for a wide range of applications, such as projecting on the ceiling or on the floor. Six separate optional lenses can enhance viewing quality from various distances – up to an astonishing 77.6 meters.



A completely different point-of-view

If you need to use multiple projectors, you can use the warping and blending tool to coordinate the projections of the same images thanks to technology that overlap the images to give a smooth larger view. You can even show two images at the same time, by using Picture In Picture or Picture By Picture settings. And you add an optional higher-grade color wheel for more vivid and natural colours.



PJ KU12000

MAIN SPECIFICATIONS

GENERAL

Projection system:	Single chip DLP
Resolution:	1,920 x 1,200 pixels
Panel:	Panel size: 0.96 inch Aspect ratio: 16:10
Brightness:	12,000 lumen
Contrast ratio:	5,000:1
Projection screen size:	Depends on lens
Projection distance:	Depends on lens
Lamp:	High-pressure mercury lamp (Dual)
Lamp life:	Standard: 1,500 hours (465 W) Eco mode 1: 2,000 hours
RGB compatible signals :	WUXGA
Input signals:	NTSC, PAL, SECAM, HDTV, EDTV, SDTV
Zoom ratio:	Depends on lens
Zoom:	Motorized
Focus:	Motorized
Connection terminal:	D-SUB 9pin x 1 (PC Control), HDMI x 1, RJ45 (for control), TYPE-A x 1 (USB), DVI-D x 1, 3.5 mm mini Jack x1/x2 , Computer In x 1, Computer OUT x 1, 3D Sync x 1, 5BNC x 1, 3G-SDI IN x 1, Video IN x 1
USB:	Type-A x 1 Mini USB x 1 (for service)
Wired LAN:	RJ-45 x 1 (10BASE-T/ 100BASE-TX/1000BASE-T)
Primary features:	Auto keystone, Lens shift, 360 degrees tilt-free , Portrait mode , Picture in picture , Geometric correction, Blending
Network features:	PJ Link, Crestron, AMX
Dimensions (W x D x H):	520 x 591 x 194 mm
Weight:	23.8 kg
Power source:	100 - 240 V, 50/60 Hz

ECOLOGY

Power consumption:	Operating power: 1,150 W Energy Saver mode: 920 W
Operating temperature:	0°C - 40°C
Operating humidity:	10% - 85%
Noise level:	Stand-by: 38 dB Operating mode: 41 dB

ACCESSORIES

Power cable, Read this first / Manual (Starting Guide), VGA cable, CD-ROM and manual, Remote control with batteries, DVI-HDMI adapter

CONSUMABLES

Replacement lamp Type 25, Replacement lens Type B1/B2/B3/B4/B5/B6, Replacement colour wheel Type 1, Replacement air filter Type 5

For availability of models, options and software, please consult your local supplier.

ISO9001 certified, ISO14001 certified, ISO27001 certified

All brand and/or product names are trademarks of their respective owners.

Specifications and external appearance are subject to change without notice. The colour of the actual product may vary from the colour shown in the brochure. The images in this brochure are not real photographs and slight differences in detail might appear.

Copyright © 2017 Ricoh Europe PLC. All rights reserved. This brochure, its contents and/or layout may not be modified and/or adapted, copied in part or in whole and/or incorporated into other works without the prior written permission of Ricoh Europe PLC.

RICOH
imagine. change.

www.ricoh-europe.com