

A4 Colour Printer

SP C352DN

RICOH
imagine. change.

✓ Printer



SP C352DN

30
ppm B/W
Colour

An easy solution to help you realise your dreams.

We know your business never stands still. And at Ricoh, we realise that versatility of speed combined with the highest-quality output – even at 30ppm – will help you achieve more. Designed for workgroups with big ideas, this reliable A4 colour model offers a variety of options to boost productivity and creativity. Thanks to its compact nature, you can position it almost anywhere. But you also get low Total Cost of Ownership, the ability to handle a variety of paper stocks and the option of WiFi Direct connectivity.

- Easy-to-use, 4.3-inch colour touch panel
- LED technology that offers 1200dpi x 1200dpi at full speed
- Lower your company's expenditure with competitive running costs
- Instant printing from portable USB media via the USB-port
- Print from any device via AirPrint and Ricoh Smart Device Print&Scan app



Perfectly practical in every way.

As versatile as you are.

Its compact nature means you can position the SP C352DN almost anywhere in an office or branch environment. With such high functionality, there's always a place for this easy-to-use, yet advanced device. It will handle a variety of different paper options and it also offers banner printing capabilities too.



A powerful way to reduce costs.

Offering a best in class low typical energy consumption (TEC value) and a low Total Cost of Ownership, this model will save on your power costs with its energy-saving sleep mode. Recovering from the sleep mode in 7.5 seconds, it will also keep productivity high ensuring no time is wasted – helping you reach your goals.

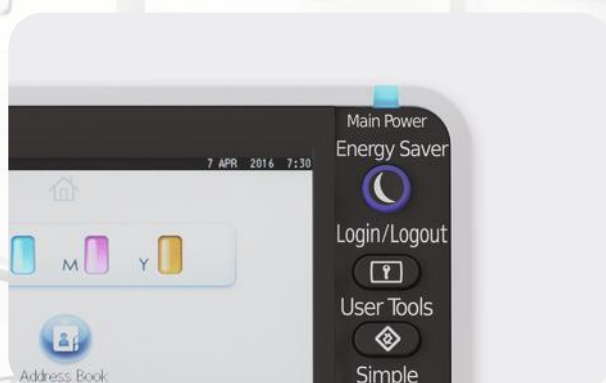

More hands-on. More mobile.

The SP C352DN is mobile ready and prepared for today's connected world. This printer gives you the option to quickly and securely send documents to print from Smart Devices. And its customisable 4.3 inch touch panel has an interface that's easy to navigate and discover everything you need to know – including information like ink status and print queues. Its functional design also fits right into Ricoh's A3 MFP-fleet.



The technology to do even more.

Work better and more flexibly too with everything you would expect from an A4 colour model, but with document sharing options, integration with major platforms and third-party software – as well as an easy integration with your MFP fleet. Our optional Flexrelease CX and Streamline NX software will let you securely access your cloud-based documents and print directly from the cloud.



SP C352DN

MAIN SPECIFICATIONS

GENERAL

Technology:	LED
Warm-up time:	18 seconds
First output speed:	Full colour: 7.8 seconds B/W: 6 seconds
Print speed:	Full colour: 30 pages per minute B/W: 30 pages per minute
CPU:	Intel Atom Processor Bay Trail: 1.46 GHz
Memory:	Standard: 2 GB Maximum: 2 GB
HDD (option):	320 GB (Encryption/Data Overwrite Security unit)
Duty cycle:	75,000 prints per month
Duplex:	Standard
Dimensions (W x D x H):	400 x 515 x 387 mm
Weight:	33 kg
Power source:	220 - 240 V, 50/60 Hz

PRINTER

Printer language:	Standard: PCL5c, PCL6, PostScript 3 (emulation), PDF direct Option: Genuine Adobe ®PostScript®3™, XPS, PictBridge
Print resolution:	600 x 600 dpi, 600 x 1,200 dpi equivalent, 600 x 2,400 dpi equivalent, 1,200 x 1,200 dpi
Fonts:	PCL (93 fonts), PS3 (Emulation) (80 fonts), PS3/PDF (136 fonts)
Interface:	Standard: USB 2.0, USB Host I/F, Ethernet 10 base-T/100 base-TX/1000 base-T Option: Wireless LAN (IEEE 802.11a/b/g/n), Bi-directional IEEE 1284/ECF
Network protocol:	TCP/IP (IP v4, IP v6), Bonjour, lPsec
Windows® environments:	Windows® Vista, Windows® 7, Windows® 8, Windows® 8.1, Windows® 10, Windows® Server 2008, Windows® Server 2008R2, Windows® Server 2012, Windows® Server 2012R2
Mac OS environments:	Macintosh OS X Native v10.7 or later
UNIX environments:	UNIX Sun® Solaris: 9, 10 HP-UX: 11.x, 11i v2, 11i v3 SCO OpenServer: 5.0.7, 6.0 RedHat® Linux Enterprise: 4, 5, 6 IBM® AIX: 5L v5.3, 5L v6.1, 5L v7.1
SAP® R/3® environments:	SAP® R/3®

PAPER HANDLING

Recommended paper size:	Standard paper tray(s): A4, A5, A6, B5, B6 Bypass tray: A4, A5, A6, B4, B5, B6
Paper input capacity:	Maximum: 2,100 sheets
Paper output capacity:	Maximum: 200 sheets
Paper weight:	Paper tray(s): 56 - 220 g/m² Bypass tray: 56 - 220 g/m²
Media capability:	Plain paper, Middle thick paper, Thick paper, Recycled paper, Colour paper, Letterhead, Pre-printed paper, Thin paper, Special paper, Label paper, Envelopes, Bond, Cardstock, Coated paper, Labels, Glossy paper, Waterproof, Back Copied Paper, Coated paper

ECOLOGY

Power consumption:	Maximum: 1.2 kW Ready mode: 40.2 W Sleep mode: Less than 0.6 W TEC (Typical Electricity Consumption): 1.16 kWh
--------------------	---

SOFTWARE

Standard:	SmartDeviceMonitor, Web Image Monitor, Remote Communication Gate S Pro
Optional:	Streamline NX, CAP Type L, CAP Type I, ELP-NX V2, ELP-NX FS V2, FlexRelease CX, Device Manager NX Lite, Device Manager NX Accounting, Device Manager NX Pro, Device Manager NX Enterprise, RICOH @Remote Connector NX

OPTIONS

3 x 250-sheet paper tray, 3 x 500-sheet paper tray, Bi-directional IEEE 1284, Wireless LAN (IEEE 802.11a/b/g/n), USB Server for Second Network Interface, VM Card, Pictbridge, PostScript3, XPS direct print

CONSUMABLES

Toner capacity:	Black: 10,000 prints Cyan: 9,000 prints Magenta: 9,000 prints Yellow: 9,000 prints Declared yield value in accordance with ISO/IEC 19752
Starter toner:	Black: 4,000 prints Cyan: 3,500 prints Magenta: 3,500 prints Yellow: 3,500 prints
PCU yield:	Black: 15,000 prints Cyan: 12,000 prints Magenta: 12,000 prints Yellow: 12,000 prints

For availability of models, options and software, please consult your local supplier.



RICOH @Remote



RICOH
imagine. change.

www.ricoh-europe.com

ISO9001 certified, ISO14001 certified, ISO27001 certified
All brand and/or product names are trademarks of their respective owners.
Specifications and external appearance are subject to change without notice. The colour of the actual product may vary from the colour shown in the brochure. The images in this brochure are not real photographs and slight differences in detail might appear.

Copyright © 2017 Ricoh Europe PLC. All rights reserved. This brochure, its contents and/or layout may not be modified and/or adapted, copied in part or in whole and/or incorporated into other works without the prior written permission of Ricoh Europe PLC.